

VOCAL-STAR USER MANUAL

2.0 Channel Soundbar

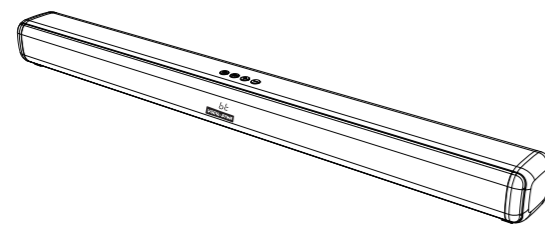

MODEL: VS-VB

Thanks for purchasing **VOCAL-STAR VS-VB**. This guideline aims to offer you details on setting up this soundbar so that you can enjoy the ultimate sound experience.

ACCESSORIES:

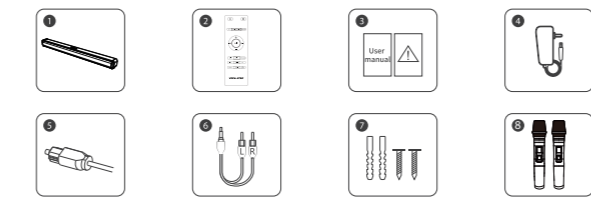

● Power adaptor ● Optical cable ● AUX audio cable ● Wall mounting bolts ● Microphone

DIAGRAM (BUTTONS , PORTS & INDICATOR)

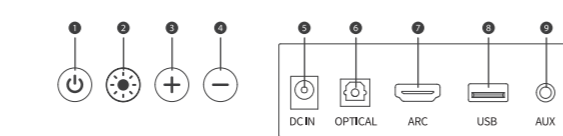

- : Short press to turn on, long press to turn off. After boot, tap to switch mode.
- : Long press to turn the LED light on/off, short press to switch to the following mode.
Light Mode: 1. breathing 2. circulate1 3. red 4. green 5. blue 6. Gradual change 7. circulate2 8. circulate3 9. circulate4 10. White
- : Volume +
- : Volume -
- DC15V IN Jack.
- **OPTICAL IN**: Connect to the compatible devices via an optical cable(provided)
- **HDMI(ARC)**: Connect to the compatible devices via a HDMI cable(not provided)
- **USB IN**: Connect to the flash drive for playing MP3/WAV files (FAT32 format and 64GB max)
- **AUX IN**: Connect to the compatible devices via the 3.5mm-PCA stereo jack cable(provided)

MODE

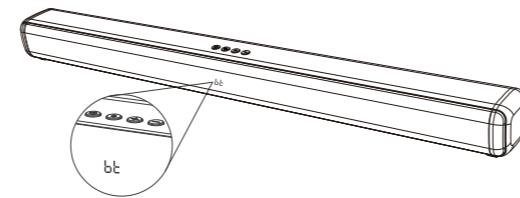

ARC	HDMI(ARC)mode	bt	Bluetooth mode
USB	USB media mode	AUX	Auxiliary input mode
OPT	Optical mode		

PLACEMENT

A. Table Placement

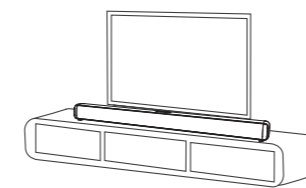

Placement
Table placement
Place the soundbar on a solid surface.

B. Wall Mounted

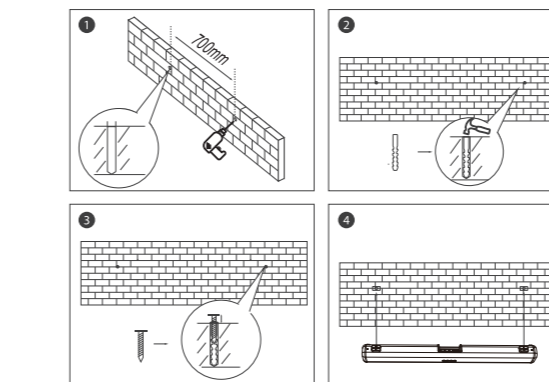

REMOTE CONTROL

Battery installation

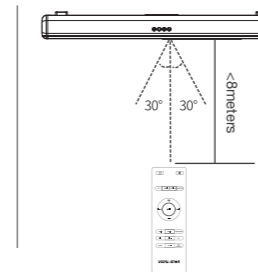
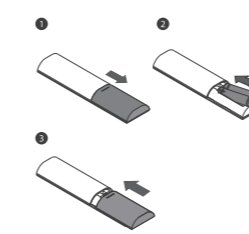

Use remote control
The working range of remote is +/-30° in both Vertical and Horizontal Direction.

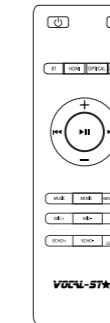

	Short press to turn on, long press to turn off	MUSIC	Music Mode/EQ1
	Mute/Recover the Volume	MOVIE	Movie Mode/EQ2
BT	Go to BT Mode	NEWS/Game	News mode is displayed as EQ3/Game mode is displayed as EQ4
HDMI	Go to HDMI Mode	OPTICAL	Go to Optical Mode
MIC+	Microphone volume +		
MIC-	Microphone volume -		
AUX/USB	Go to Aux/USB Mode	ECHO+	Reverberation volume +
+	Volume Up	ECHO-	Reverberation volume -
-	Volume Down	3D	3D Surround sound on/off, can only be turned on in movie mode
⏮	Previous Track	⏭	Next Track
⏸	Play/Pause	⏻/LED OFF	Long press the switch to turn on/off, short press the cycle to switch the LED mode

USING YOUR SOUNDBAR

A. Power Connection

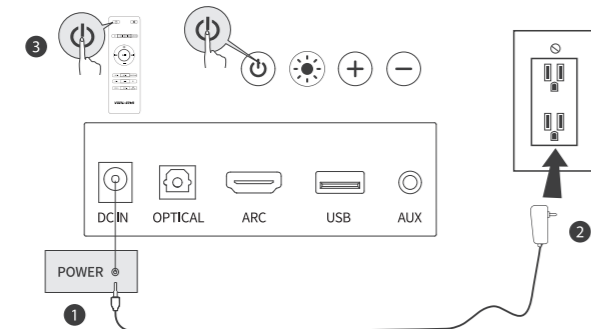

B. Connect to TV

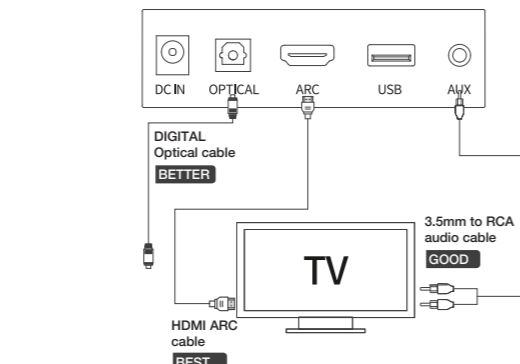

Use Remote Control or Button on Soundbar to change modes.

Note:

1. Prior to usage, check whether your TV has HDMI ARC, Optical and Aux Output.
2. Prior to using HDMI ARC connection, please ensure your TV supports HDMI ARC and HDMI Cable is not lower than HDMI1.4.
3. Turn on PCM settings of your TV When connected in Optical Mode in case there is no sound.
4. 32 is the maximum volume of the soundbar.

Troubleshooting:

Please scan the QR code for Some TV Connection Guides.



C. Connect to Other Devices

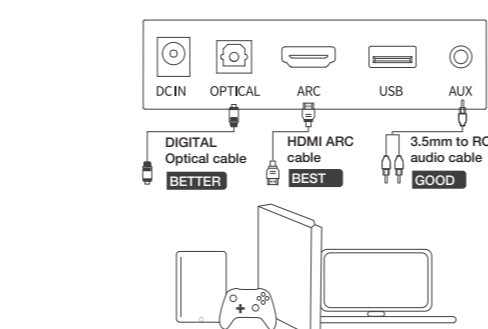

Need to purchase one 3.5mm-3.5mm audio cable if there is only 3.5mm female output on your Devices.

D. Connect to Bluetooth Device



Short press "BT" button on the remote control or on the soundbar to enter Bluetooth mode. The BT will flash when entering the pairing mode, and will stop flashing once successfully paired

SPECIFICATION:

Model: VS-VB	Distortion: <0.5%
Sound Channel: 2.0	DC: 15V/2A
Driver: (58X98mm)×2PCS	Power: 300W
Functional Jacks: Optical×1, HDMI ARC×1, USB×1, AUX×1	BT Version: 5.0
Product Dimensions: L860×D85×H70mm	Product Weight: 1.7KG
Power Supply: AC 100-240V 50/60Hz	

Safety Instructions

1. Avoid dropping
2. Do not disassemble
3. Avoid extreme temperatures
4. Don't use the device outdoors during thunderstorms
5. Use original or certified cables
6. Don't use any corrosive cleaner /oil to clean
7. The products should not be exposed to dripping or splashing water

Microphone instruction



1. the simple use of two, No.5 1.5V batteries. If you want to use for a long time, it is recommended to buy batteries, please look for the "alkaline battery" purchase, alkaline battery is more durable.
2. do not use the microphone for a long time, it is recommended to take out the battery.
3. When screaming occurs in the process of use, the microphone should keep a certain distance from the sound
4. the microphone appears boot without display or display without sound, the first rule out whether the battery is installed wrong or battery power is insufficient, replace the battery.